



MADE IN CHINA

SHENZHEN FZONE TECHNOLOGY CO., LTD.

2nd floor, Building 12, Xicheng Industrial Area, Xixiang Town,
Baoan District, Shenzhen Guangdong China. 518101

E-mail: support@xvive.com

Tel: +86-755-2912 3526

www.xvive.com

PATENT PENDING



U35 U35D

MICROPHONE WIRELESS SYSTEM

For Dynamic Microphones and PA/DJ Systems
with active speakers

English Manual



5.8 GHz
Plug and Play

INTRODUCTION

The Xvive U35 Microphone Wireless System (for dynamic mics and audio transmission) operates on the 5.8 GHz frequency for better signal stability and less interference. It includes a compact Transmitter and Receiver, offering high-quality audio with low latency. Ideal for live performances and recordings, wireless audio transmission, it sets up in seconds and provides a reliable, long-lasting wireless connection. Perfect for singers, speakers, audio engineer, and content creators, it allows anyone to turn their favorite dynamic microphone into a wireless microphone!



CAUTION
RISK OF ELECTRIC SHOCK
DO NOT OPEN



WARNING:

TO REDUCE THE RISK OF FIRE OR ELECTRIC SHOCK, DO NOT REMOVE SCREWS.

NO USER-SERVICEABLE PARTS INSIDE.

REFER SERVICING TO QUALIFIED SERVICE PERSONNEL.

WARNING:

TO REDUCE THE RISK OF FIRE OR ELECTRIC SHOCK, DO NOT EXPOSE THE APPLIANCE TO RAIN OR MOISTURE.



Radio Approvals: FCC Part 15.249, RSS-247(Canada), EN 300 440 (Europe), EN 301.489 (Europe)

This device is in compliance with the essential requirements and other relevant provisions of Directive 2014/53/EU. All essential radio test suites have been carried out.

The Korean version has passed KC certification.

Detailed DOC file please visit our website: www.xvive.com

IC CAUTION:

This device complies with Industry Canada licence-exempt RSS standard(s). Operation is subject to the following two conditions:
(1) this device may not cause interference,
(2) this device must accept any interference, including interference that may cause undesired operation of the device.

Le présent appareil est conforme aux CNR d'Industrie Canada applicables aux appareils radio exempts de licence. L'exploitation est autorisée aux deux conditions suivantes :

- (1) l'appareil ne doit pas produire de brouillage, et
- (2) l'utilisateur de l'appareil doit accepter tout brouillage radioélectrique subi, même si le brouillage est susceptible d'en compromettre le fonctionnement.

FCC CERTIFICATION

FCC Caution: Any changes or modifications not expressly approved by the party responsible for compliance could void the user's authority to operate this equipment.

This device complies with Part 15 of the FCC Rules. Operation is subject to the following two conditions:

- (1) This device may not cause harmful interference, and
- (2) this device must accept any interference received, including interference that may cause undesired operation.

NOTE:

This equipment has been tested and found to comply with the limits for a Class B digital device, pursuant to Part 15 of the FCC Rules.

These limits are designed to provide reasonable protection against harmful interference in a residential installation. This equipment generates, uses and can radiate radio frequency energy and, if not installed and used in accordance with the instructions, may cause harmful interference to radio communications.

However, there is no guarantee that interference will not occur in a particular installation.

If this equipment does cause harmful interference to radio or television reception, which can be determined by turning the equipment off and on, the user is encouraged to try to correct the interference by one or more of the following measures:

- Reorient or relocate the receiving antenna.
- Increase the separation between the equipment and receiver.
- Connect the equipment into an outlet on a circuit different from that to which the receiver is connected.
- Consult the dealer or an experienced radio/TV technician for help.

FCC ID: 2AJ30-U35 IC: 22031-U35



WARNING: Risk of reproductive harm from exposure to Phthalates.
www.P65Warnings.ca.gov

SAFETY INSTRUCTIONS FOR LITHIUM-ION RECHARGEABLE BATTERIES

If abused or misused, the rechargeable batteries may leak. In extreme cases, they may even present a risk of explosion, fire, heat, smoke or gas. Xvive does not accept any liability for damage arising from abuse or misuse.

- Keep away from children.
- Only charge rechargeable batteries with chargers recommended by Xvive.
- Observe correct polarity.
- Pack/store charged rechargeable batteries so that the terminals cannot contact each other (danger of shorting out/fire hazard).
- Do not expose to moisture.
- Switch rechargeable battery-powered products off after use.
- Only charge rechargeable batteries at ambient temperatures between 10°C/50°F and 40°C/104°F.
- When not using rechargeable batteries for extended periods of time, charge them regularly (about every three months).
- Do not mutilate or dismantle.
- Do not heat above 60°C/140°F, e.g. do not expose to sunlight or throw into a fire.

- Immediately remove rechargeable batteries from obviously defective products.
- Do not continue to use defective rechargeable batteries.
- Only use rechargeable batteries specified by Xvive.
- Dispose of rechargeable batteries at special collection points or return them to your specialist dealer.
- Store the products in a cool and dry place at room temperature (approx. 20°C/68°F).
- Remove the rechargeable batteries if the products will not be used for extended periods of time.



Hereby, **SHENZHEN FZONE TECHNOLOGY CO., LTD**, declares that this type of equipment is in compliance with the essential requirements and other relevant provisions of Directive 2014/53/EU

INFORMATION ABOUT COLLECTION AND DISPOSAL OF OLD ITEMS AND USED BATTERIES

[For customers in the European Union]

If you want to discard electronic items, please contact your dealer or supplier for further information.

These symbols on the products, packaging, or on any documents in the package mean it is incorrect to mix the used electrical and electronic products and batteries with general household garbage. These symbols are only valid in the EU. Please contact your local authorities or dealer for more information on the disposal of old items and used batteries:



To protect our environment, please take old products and used batteries to proper collection places, and follow your national legislation and the Directives 2012/19/EU and 2006/66/EC.

[Information on Disposal in Countries outside the European Union]

To deal with these old products and batteries properly, please help to save valuable resources and prevent any possibility of side effects on human health and our environment due to the inappropriate disposal of the old products and used batteries.

Please contact your local authorities to get more helpful information on how to dispose of old products and batteries.

ONE-YEAR LIMITED WARRANTY

Xvive Corporation Ltd. [Xvive] warrants our products to be free of defects in materials and workmanship in normal use for a period of one (1) year from the date of original purchase. Please visit <https://www.xvive.com> to register your new purchase.

Xvive will, at its sole discretion, or in affiliation with our authorized retailers, repair or replace at no charge, any unit that is inspected by Xvive or an affiliated Xvive service center and deemed to be defective within the warranty period. This warranty is non-transferrable.

This warranty is only valid to the original purchaser, only when purchased "new-in-box" from an Authorized Xvive Dealer and with a valid proof of purchase bearing the purchase date.

Within the USA:

- All Xvive warranty claims should be made with the retailer from which the unit was purchased. This applies to both retail stores and online retailers.

Outside of the USA:

- For all warranty and non-warranty claims, the purchaser should contact the Authorized Xvive Retailer from which the unit was purchased within the country or province in which it was purchased for information on how to obtain warranty or non-warranty service.

This limited warranty does not cover the following:

- Products that have been modified in any way;
- Any products whose serial numbers have been altered or removed;
- Exterior cosmetic damage or damage to the finish due to misuse or normal wear and tear;
- Products that were purchased as "used", items listed as demo stock or refurbished items;
- Damage to the product or parts caused by improper storage by the user;
- Any freight charges (from or to the retailer);
- Shipping Damage:

- Shipping damage claims must be filed with the freight carrier (such as UPS, FedEx).
- Notify the freight carrier immediately of any shipping damage upon receipt of damaged items to begin the claim process.
- We also recommend reporting any shipping damage claim within (48) hours of receipt to the Authorized Retailer from which the item was purchased.
- Keep all original documents and packing materials until freight damage claim has a final resolution.

For units returned to Xvive USA:

- The item must be returned in the same format in which it was purchased. If a system containing a transmitter and receiver was purchased, then both units will need to be returned together.
- The purchaser will pay all freight charges to return the original item to Xvive USA or its affiliated service centers.
- If the unit is deemed to be covered by this warranty, Xvive will ship the repaired or replacement unit to the purchaser free-of-charge and without any additional freight charges.
- If the unit is deemed to NOT be covered by this warranty, other charges plus return freight charges will apply.

EXCEPT AS EXPRESSLY SET FORTH ABOVE IN THIS LIMITED WARRANTY, XVIVE MAKES NO OTHER EXPRESS OR IMPLIED WARRANTIES TO THE EXTENT PERMITTED BY LAW. XVIVE ASSUMES NO LIABILITY FOR PROPERTY DAMAGE RESULTING FROM FAILURE OF THIS PRODUCT NOR ANY LOSS OF INCOME, SATISFACTION, OR DAMAGES ARISING FROM THE LOSS OF USE OF SAME DUE TO DEFECTS OR AVAILABILITY OF SAME DURING SERVICE. THIS WARRANTY GIVES YOU SPECIFIC LEGAL RIGHTS AND YOU MAY ALSO HAVE OTHER RIGHTS WHICH VARY FROM STATE TO STATE OR BY COUNTRY OR PROVINCE.

For warranty inquiries not covered in this policy, please contact support@xvive.com

IMPORTANT SAFETY INSTRUCTIONS
PLEASE READ THESE INSTRUCTIONS AND KEEP THEM IN A SAFE PLACE



**WARNING: BEFORE USING YOUR XVIVE 5.8 GHz WIRELESS SYSTEM
CAREFULLY READ THE OPERATING INSTRUCTIONS.**

1. Observe all instructions carefully in the U35 manual.
2. Do not to perform service operations beyond those described in the U35 manual. Service is required when the apparatus has been damaged in any way, such as:
 - Liquid has been spilled or objects have fallen into the apparatus;
 - The unit has been exposed to rain or moisture;
 - The unit does not operate normally or changes in performance in a significant way;
 - The unit is dropped or the enclosure is damaged
3. Do not place near heat sources, such as radiators, heat registers, or appliances that produce heat.
4. Guard against objects or liquids entering the device. Do not use or place unit near water.
5. Clean only with a dry cloth.
6. Only use attachments/accessories specified by the manufacturer.

FEATURES

- 5.8 GHz True Diversity wireless system
- 6 wireless channels
- Less than 5 ms latency
- 5 hours of battery life
- Mic Mode for microphone and Line Mode for audiotransmission
- Wide 20 Hz - 20 kHz frequency response
- High-resolution 24-bit / 48 kHz audio
- 110 dB dynamic range
- 110 dB signal-to-noise ratio
- Wireless range: up to 100 ft; depends on RF signal absorption, reflection and interference
- For use with XLR dynamic microphones, battery-powered condenser microphones and wireless audio transmission to active PA speakers
- The U35 system allows you to avoid the hassles and tangles of cables, with a flexible, all-in-one solution that turns your favorite dynamic microphone into a wireless microphone

PACKAGE DETAILS

U35

U35 Transmitter	1PCS
U35 Receiver	1PCS
USB Cable	1PCS
Manual	1PCS
Bag	1PCS

U35D

U35 Transmitter	2PCS
U35 Receiver	2PCS
USB Cable	2PCS
Bag	2PCS
XLR female to XLR male adapter	1PCS
Manual	1PCS

QUICK START

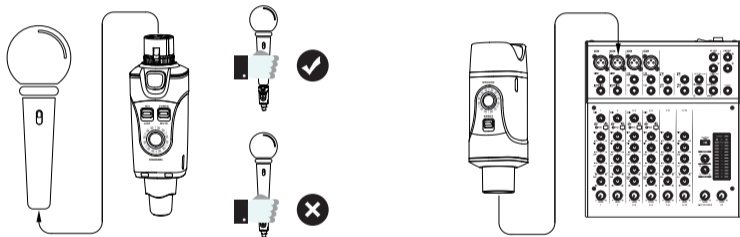

1. Plug the Transmitter into your XLR dynamic microphone or battery-powered condenser microphone.

2. Plug the Receiver into the desired XLR input channel on your mixer.

QUICK START



3. Turn on the Transmitter and the Receiver and set them both to the same channel.
4. When connected successfully, the Receiver's LED will illuminate.
5. Check the connection by talking through the microphone.

QUICK START: MONO CONNECTION TO A POWERED SPEAKER

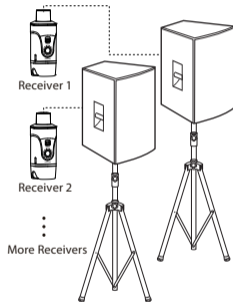
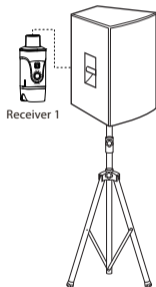
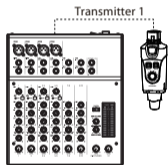

1. Connect the Transmitter to a Main or Aux XLR output of the mixer or other audio source, using the XLR-to-1/4" adapter if necessary.

2. Connect the Receiver to the XLR input of a powered PA loudspeaker or monitor.

3. Set the Receiver to the same channel as the Transmitter. The Transmitter can be paired with two or more receivers, as long as they are all set to the same channel.

QUICK START: TWO U35 SETS FOR STEREO / DUAL MONO PA APPLICATIONS

For stereo PA/DJ systems, connect Transmitter #1 to the left main XLR output of the mixer, and connect Receiver #1 to the XLR input of the left main loudspeaker. When you power them on, set them both to the same channel. Then, connect Transmitter #2 to the right main XLR output of the mixer, and connect Receiver #2 to the XLR input of the right main loudspeaker. When you power them on, set them both to the same channel, which must be a different channel than set #1.

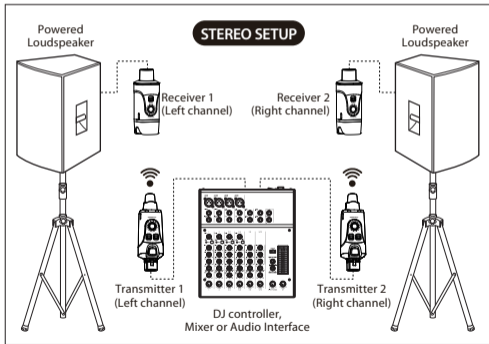

For mono PA/DJ systems, connect Transmitter #1 to the mono main XLR output of the mixer, and connect Receiver #1 to the XLR input of one of the main loudspeakers. When you power them on, set them both to the same channel. Then, connect Receiver #2 to the XLR input of the second main loudspeaker. When you power it on, set it to the same channel as set #1. Both speakers will receive the same mono signal.

OVERVIEW: U35 TRANSMITTER

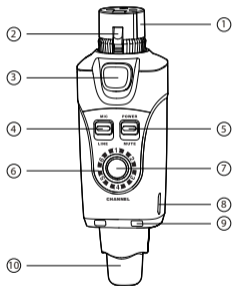

- ① **XLR IN:** XLR input jack
- ② **Spring:** Circumferential grounding spring for providing a reliable connection to the male XLR plug
- ③ **Lock button:** Unlocks the transmitter from the XLR port
- ④ **Input mode / level switch:**
MIC = 0 dB input LINE = -10 dB input
- ⑤ **Power switch:** switches unit on/off
- ⑥ **Channel status LED:** indicates selected channel
- ⑦ **Channel switch:** selects channels 1-6
- ⑧ USB charging port
- ⑨ **Power status LED:**
LED off = 100% ~ 30%
Solid red = 29% ~ 11%
Flickering red = less than 10%
- ⑩ **Antenna**

OVERVIEW: U35 RECEIVER

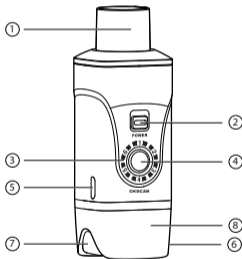

- ① **XLR OUT:** XLR output jack
- ② **Power switch:** switches the unit on and off
- ③ **Channel status LED:** indicates selected channel
- ④ **Channel switch:** selects channels 1-6;
Hold for 3 seconds to scan for the best channel
- ⑤ **USB Port:** connects to 5V USB power for charging the battery
- ⑥ **RF Status LED:**
ON = Transmitter is on and connection is established
Flashing = Signal connection interference
OFF = Transmitter is off or unlinked
- ⑦ **Power status LED:**
LED off = 100% ~ 30%
Solid red = 29% ~ 11%
Flickering red = less than 10%
- ⑧ **Antenna**

BATTERIES AND CHARGING

BATTERIES AND CHARGING

The U35 system comes with a dual USB charging cable, which charges the Transmitter and the Receiver at the same time. Plug it into any 5V / 2A USB charger adapter or USB power source.

Note: Turn off the power while charging. Please do not use U35 while charging, as this may reduce battery life.

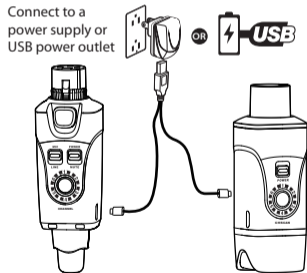

LED INDICATIONS POWER STATUS

Green (solid):	41-100%	CHARGING TIMES	BATTERY LIFE
Yellow (solid):	6%-40%		
Red (solid):	1%-5%	30 min	1 hour
Red (blinking):	<1%	1:15	2 hours
		2:30	5 hours

- * When the red light is on, the battery is low and charging is required.
- * Always store at room temperature.
- * When storing the unit, please check the battery charge level regularly and charge if necessary.

SCAN FOR THE BEST CHANNEL

Press and hold the channel button on the Receiver for 3 seconds to enter Channel Scan mode. The Receiver's channel LED will flash during scanning and then will stay on the optimal wireless channel.

When scanning is complete, manually set the Transmitter's channel to be the same as the Receiver's channel.

*Before starting the scan, please turn off the power of the transmitter to be paired, to prevent its wireless signal from interfering with the scan.

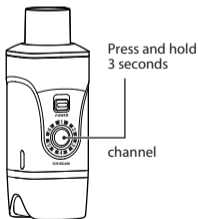

MIC AND LINE MODE

Generally, when connecting a microphone and/or connecting to an XLR output, use Mic mode. If the audio distorts due to too much signal while connected to an XLR output, switch to Line mode. Line mode will attenuate the volume by 10 dB to allow for a wider input dynamic range.

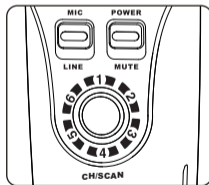

5.8 GHZ WIRELESS OVERVIEW AND INTERFERENCE

Tips for improving wireless system performance:

- 1) Keep more than 3 metres of distance between the U35 Receiver unit and Wi-Fi transmitters, such as routers.
- 2) If you experience interference from Wi-Fi devices in the vicinity, try changing to a different channel on the U35 Transmitter and Receiver.
- 3) If necessary, shorten the distance between the Transmitter and Receiver units.

INT Version: 5.8 GHz Frequency Tables

CHANNEL 1	5730 MHz, 5842 MHz, 5844 MHz
CHANNEL 2	5736 MHz, 5833 MHz, 5835 MHz
CHANNEL 3	5742 MHz, 5827 MHz, 5829 MHz
CHANNEL 4	5756 MHz, 5803 MHz, 5805 MHz
CHANNEL 5	5785 MHz, 5811 MHz, 5813 MHz
CHANNEL 6	5780 MHz, 5791 MHz, 5797 MHz

KOREA Version: 5.8 GHz Frequency Tables

CHANNEL 1	5729 MHz, 5819 MHz, 5821 MHz
CHANNEL 2	5735 MHz, 5811 MHz, 5813 MHz
CHANNEL 3	5743 MHz, 5801 MHz, 5803 MHz
CHANNEL 4	5750 MHz, 5792 MHz, 5794 MHz
CHANNEL 5	5753 MHz, 5781 MHz, 5784 MHz
CHANNEL 6	5766 MHz, 5772 MHz, 5775 MHz

* Up to six U35 sets can be used simultaneously in one area

U35D INCLUDES AN XLR-FEMALE-TO-XLR-MALE ADAPTER

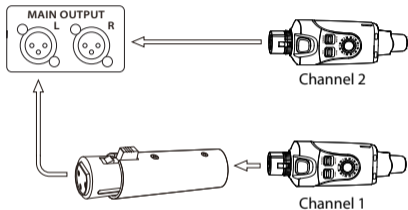

If the XLR inputs/outputs on your mixer are very close to each other, using the XLR adapter with a Transmitter allows you to plug in two Transmitters side-by-side.

EXTEND THE EFFECTIVE RANGE

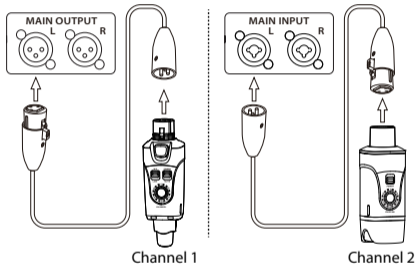

Using an XLR cable (not included) as an extension for a Transmitter allows you to connect the components to a mixer where the inputs/outputs are very close together. It can also resolve wireless signal interference issues if you have too many wireless units in the area.

SPECIFICATIONS

U35 MICROPHONE WIRELESS SYSTEM

Tuning bandwidth	Int: 5730-5844 MHz; Korea: 5729-5821MHz
Wireless signal range	Up to 100 ft. (actual range depends on RF signal absorption, reflection and interference)
Audio frequency response	20 Hz – 20 kHz (-3 dB), dependent on microphone type / input signal
Dynamic range	110 dB
Battery life	Up to 5 hours
RF sensitivity	-88 dBm
Total harmonic distortion	0.2%
RF output power	25 mW E.I.R.P. max
Operating temperature range	0°C to 45°C (battery characteristics may limit this range)
Channel count	Up to 6 channels (and U35 sets) can be used simultaneously in one area
Charging voltage and current	5V / 2A
Signal-to-noise ratio	110 dB

	U35 TRANSMITTER	U35 RECEIVER
Dimensions	31 x 29 x 98 mm	31 x 29 x 81 mm
Weight	93 g	92 g
Housing	Molded plastic and cast metal	Molded plastic and cast metal
Battery	3.7V Rechargeable Li-ion, 860 mA	3.7V Rechargeable Li-ion, 860 mA
Impedance	Input: 220 k Ω (1 kHz)	Output: 470 Ω (1 kHz)
Audio input connector	Balanced XLR female	
Audio output connector		Unbalanced XLR male
Maximum input level	Mic mode: 2.8 Vp-p / Line mode: 7 Vp-p	
Maximum output level		2.8 Vp-p
Gain adjustment range	Mic mode: 0 dB / Line mode: -10 dB	
Battery life	Up to 5 hours	Up to 5 hours
Microphone types supported	XLR-output dynamic and battery-powered XLR-output condenser	
Antenna impedance	50 Ω	50 Ω
Antenna type	1/4 wave sleeve dipole, non-removable	1/4 wave sleeve dipole, non-removable
Number of antennas	1	2

TROUBLESHOOTING

ISSUE	SOLUTION
No sound	<ul style="list-style-type: none">• Make sure that the U35 Transmitter and Receiver are set to the same channel.• Check that the U35 Receiver's RF LED is on.• Check that the microphone is properly connected to the U35 Transmitter, and turned on if necessary.• Check that the Transmitter and Receiver power switches are both turned on.• Note: Receivers can be paired with only one Transmitter at a time.
Distortion or faint sound	<ul style="list-style-type: none">• Make sure the input/gain mode is correctly set to "Line" (for an audio device such as a mixer) or "Mic" (for a microphone).• Adjust the output signal from the transmitting device (turn up if too faint, turn down if distorting)
Signal instability: RF LED flickering, or off completely	<ul style="list-style-type: none">• See "Tips for improving wireless system performance" on page 17
Unable to switch the channel	<ul style="list-style-type: none">• The channel switch locks after 30 seconds. Double-click the channel button to unlock and reset.
Multiple connections	<ul style="list-style-type: none">• One Transmitter can connect with two or more Receivers; but Receivers can only accept signal from one Transmitter.
Mixer 48V phantom power	<ul style="list-style-type: none">• The Receiver is equipped with a protection circuit, and the 48V phantom power on the mixer will not damage the Receiver.

APPLICATION OVERVIEW

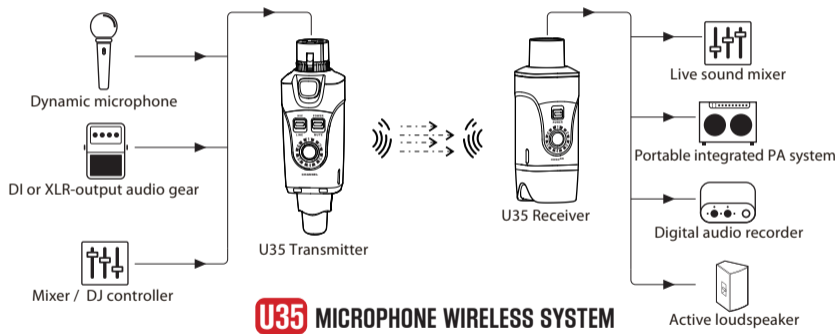

For Dynamic Microphones and PA/DJ Systems with active speakers