

9.3 EXTERIOR SECTION (2/2)

1

2

3

4

A • Bottom view

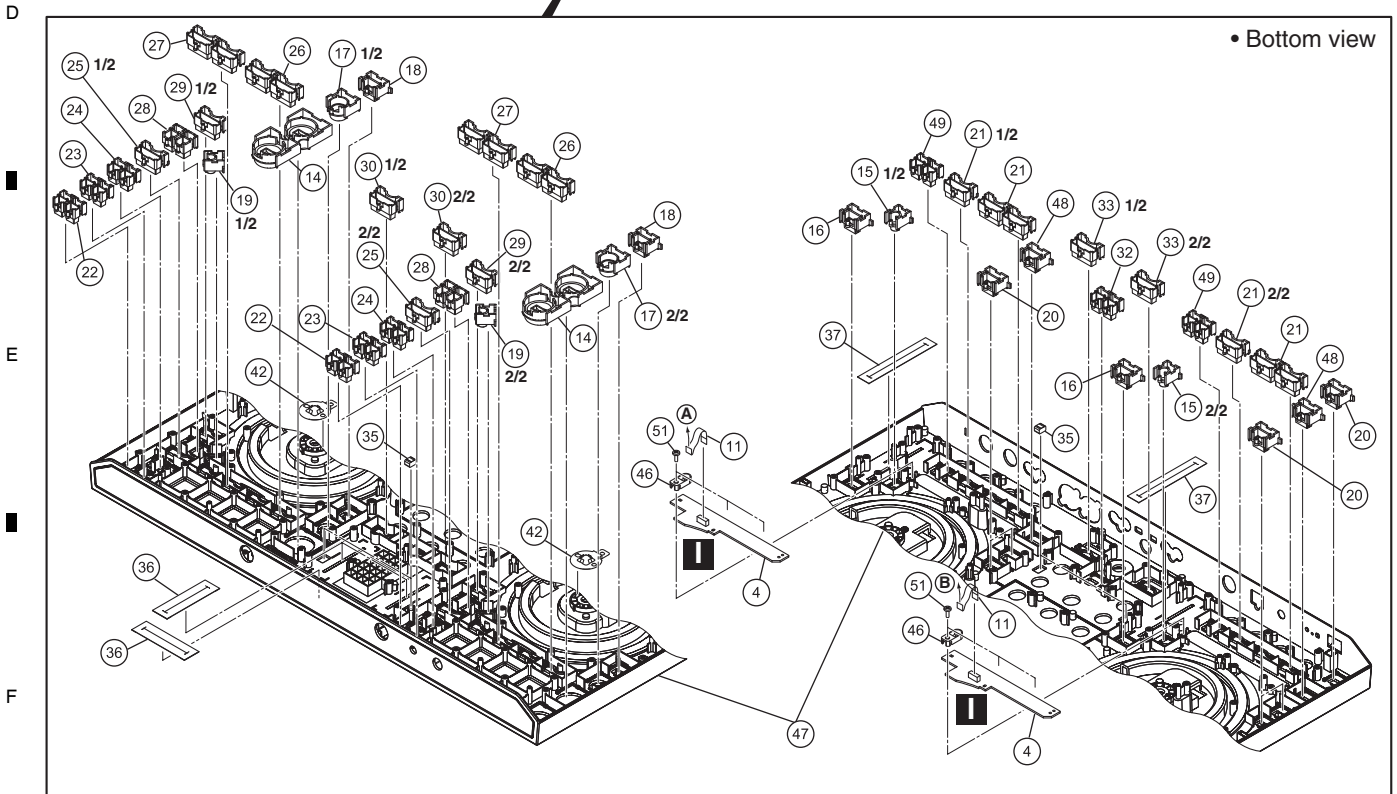
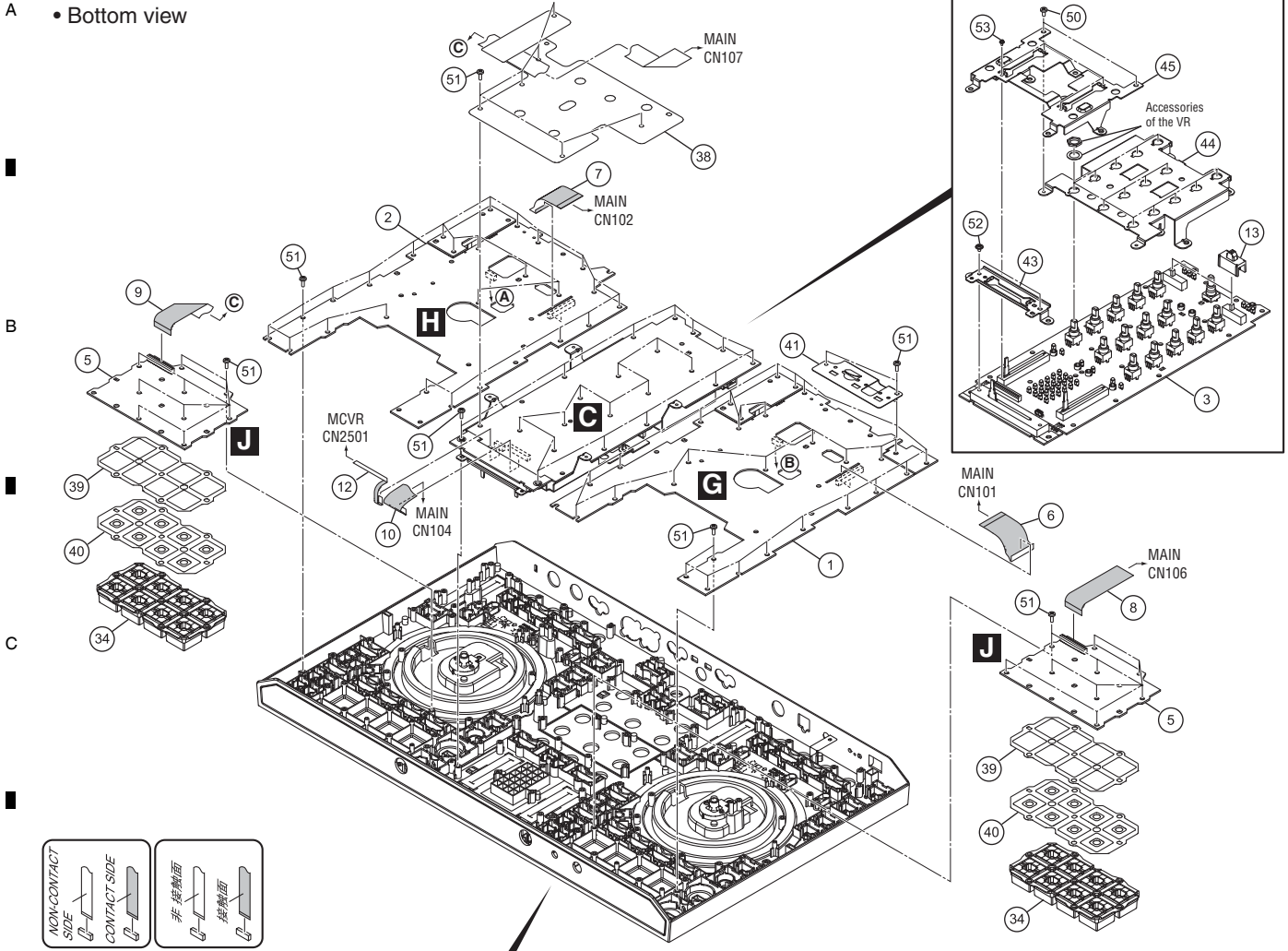

1

2

3

4

EXTERIOR SECTION (2/2) PARTS LIST

<u>Mark No.</u>	<u>Description</u>	<u>Part No.</u>	<u>Mark No.</u>	<u>Description</u>	<u>Part No.</u>
1	PNL1 Assy	DWX4121	46	CDC Stopper	DNK5863
2	PNL2 Assy	DWX4122	NSP 47	Control Panel	DNK6738
3	MIXR Assy	DWX4123	48	Button	DAC3347
4	CDC Assy	DWX3894	49	Button	DAC3351
5	PAD Assy	DWX3902	50	Screw	BBZ30P060FTC
6	FFC	DDD1773	51	Screw	BPZ30P080FNI
7	FFC	DDD1774	52	Screw	IMZ30P040FTC
8	FFC	DDD1775	53	Screw	PMH20P040FTC
9	FFC	DDD1776			
10	FFC	DDD1777			
11	FFC	DDD1782			
12	FFC	DDD1783			
13	SW Cap	DAC2753			
14	Button	DAC3236			
15	Button/MT	DAC2875			
16	Button	DAC3152			
17	Button	DAC3205			
18	Button	DAC3206			
19	Button	DAC3207			
20	Button	DAC3208			
21	Button	DAC3209			
22	Button	DAC3210			
23	Button	DAC3212			
24	Button	DAC3213			
25	Button	DAC3350			
26	Button	DAC3348			
27	Button	DAC3216			
28	Button	DAC3352			
29	Button	DAC3349			
30	Button	DAC3219			
31	•••••				
32	Button	DAC3221			
33	Button	DAC3222			
34	Button	DEB2035			
35	Gasket	DEC3719			
36	Fader Packing	DEC3355			
37	Packing/TMP	DEC3392			
38	Sheet	DEC3671			
39	Sheet	DEC3672			
40	Sheet	DEC3673			
⚠ 41	Barrier	DEC3706			
42	Plate/CND	DNH3137			
43	Stay	DNH3340			
44	Stay	DNH3265			
45	Stay	DNH3273			