

9.2 EXTERIOR SECTION (1/2)

1

2

3

4

A

B

C

D

E

F

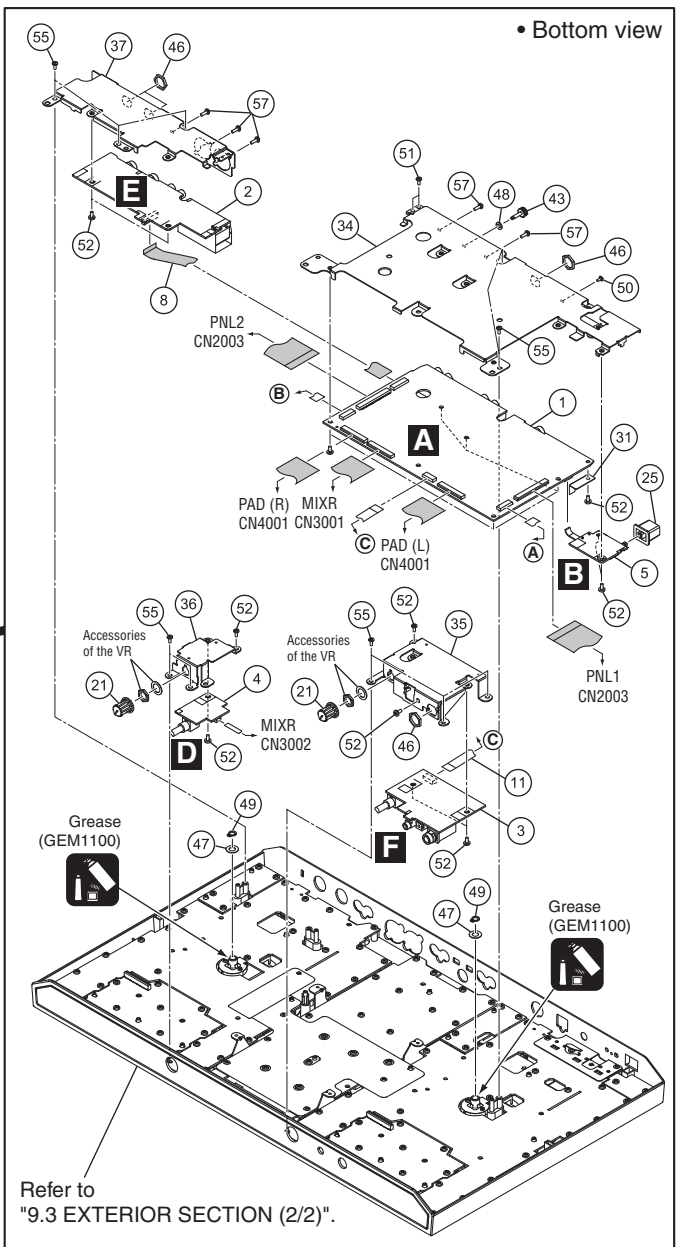
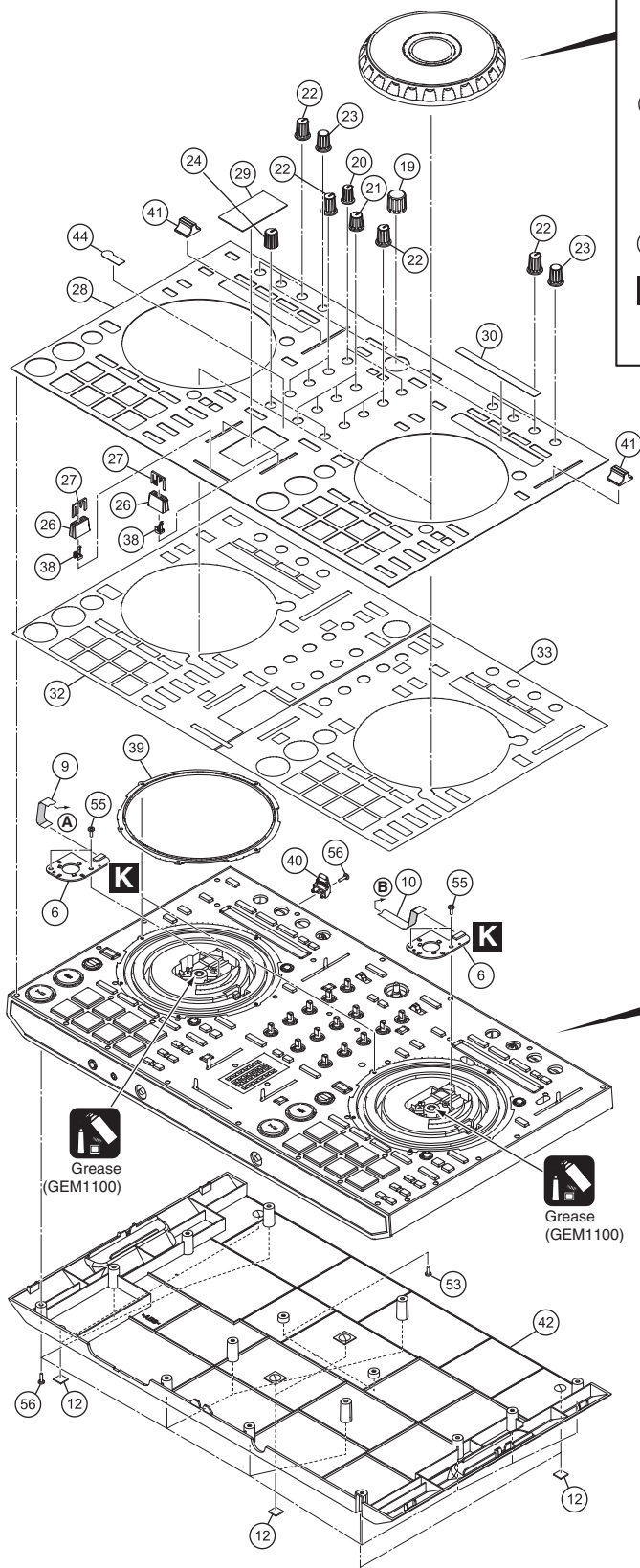
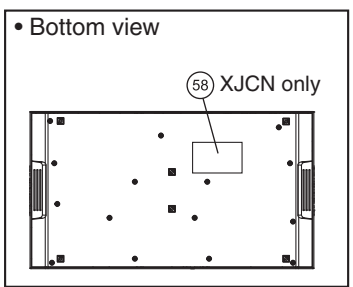
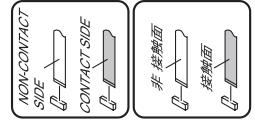
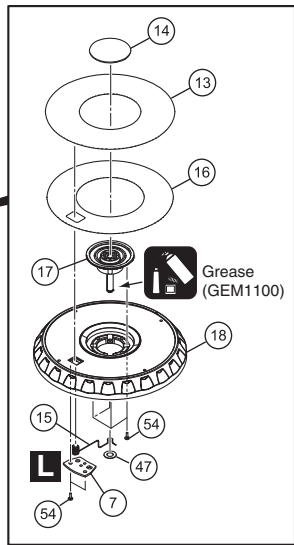

Refer to "9.3 EXTERIOR SECTION (2/2)".

1

2

3

4

EXTERIOR SECTION (1/2) PARTS LIST

Mark No.	Description	Part No.	Mark No.	Description	Part No.
1	MAIN Assy	DWX4120	△ 31	Barrier	DEC3707
2	MBJK Assy	DWX4128	NSP 32	DS Tape	DEH1085
3	HPJK Assy	DWX4129	NSP 33	DS Tape	DEH1088
4	MCVR Assy	DWX4126	34	Stay	DNH3266
5	PWSW Assy	DWX4127	35	Stay	DNH3267
6	JOG Assy	DWX3903	36	Stay	DNH3268
7	HOLD Assy	DWX4124	37	Stay	DNH3274
8	FFC	DDD1778	38	Stopper/SLD	DNK6009
9	FFC	DDD1779	NSP 39	Ring	DNK6619
10	FFC	DDD1780	40	Hook/CRD	DNK6084
11	FFC	DDD1781	41	Knob	DNK6629
12	Rubber Foot	VEB1349	42	Chassis	DNK6739
13	Plate	DAH3178	43	Earth Terminal	DKE1015
14	Window	DAH3179	44	Label	DRW2734
15	Spring	DBH1812	45	•••••	
16	DS Tape/JOG	DEH1058	46	Nut (M12)	NKX2FNI
17	JOG Dial	DNK6616	47	Washer	WA62D120D050
18	JOG Dial	DNK6737	48	Spring Lock Washer	WS40FNI
19	Dial Knob	DAA1246	49	Washer	YC60FAC
20	Knob	DAA1359	50	Screw (M3*5)	DBA1340
21	Knob	DAA1360	51	Screw	BBZ26P060FTB
22	Knob	DAA1361	52	Screw	BBZ30P060FTC
23	Knob	DAA1362	53	Screw	BBZ30P080FTB
24	Knob	DAA1366	54	Screw	BPZ20P060FTC
25	Power Knob	DAC2306	55	Screw	BPZ30P080FNI
26	Slider Knob 1	DAC2684	56	Screw	BPZ30P100FTB
27	Slider Knob 2	DAC2685	57	Screw	PPZ30P080FTB
NSP 28	Plate	DAH3177	NSP 58	Label	See Contrast table (2)
29	Panel	DAH3103			
30	Sheet	DEC3674			

Note:

Plate (No.28: DAH3177) is bonded to the double-sided tape in the Control panel (No.47: DNK6738), it is difficult to replacement. When replacing the Plate (No.28: DAH3177), please order the following service parts Assy.

Mark	No.	Part Name	Part No.	Remarks
NSP	28	DDJ-SR2 Panel Service Assy Component part	DEA1080	Refer to "9.2 EXTERIOR SECTION (1/2)"
	29	Plate	DAH3177	
	30	Panel	DAH3103	
	30	Sheet	DEC3674	
NSP	32	DS Tape	DEH1085	
NSP	33	DS Tape	DEH1088	
NSP	39	Ring	DNK6619	Refer to "9.3 EXTERIOR SECTION (2/2)"
	44	Label	DRW2734	
NSP	36	Fader Packing	DEC3355	Refer to "9.3 EXTERIOR SECTION (2/2)"
	37	Packing/TMP	DEC3392	
	47	Control Panel	DNK6738	

(2) CONTRAST TABLE

DDJ-SR2/SYXJ, UXJCB, XJCN and FWLPWXJ are constructed the same except for the following:

Mark	No.	Symbol and Description	DDJ-SR2/SYXJ	DDJ-SR2/UXJCB	DDJ-SR2/XJCN	DDJ-SR2/FWLPWXJ
NSP	58	Label	Not used	Not used	DRW2743	Not used