

9.8 LCD SECTION

1

2

3

4

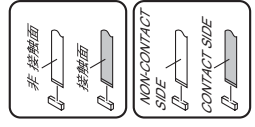
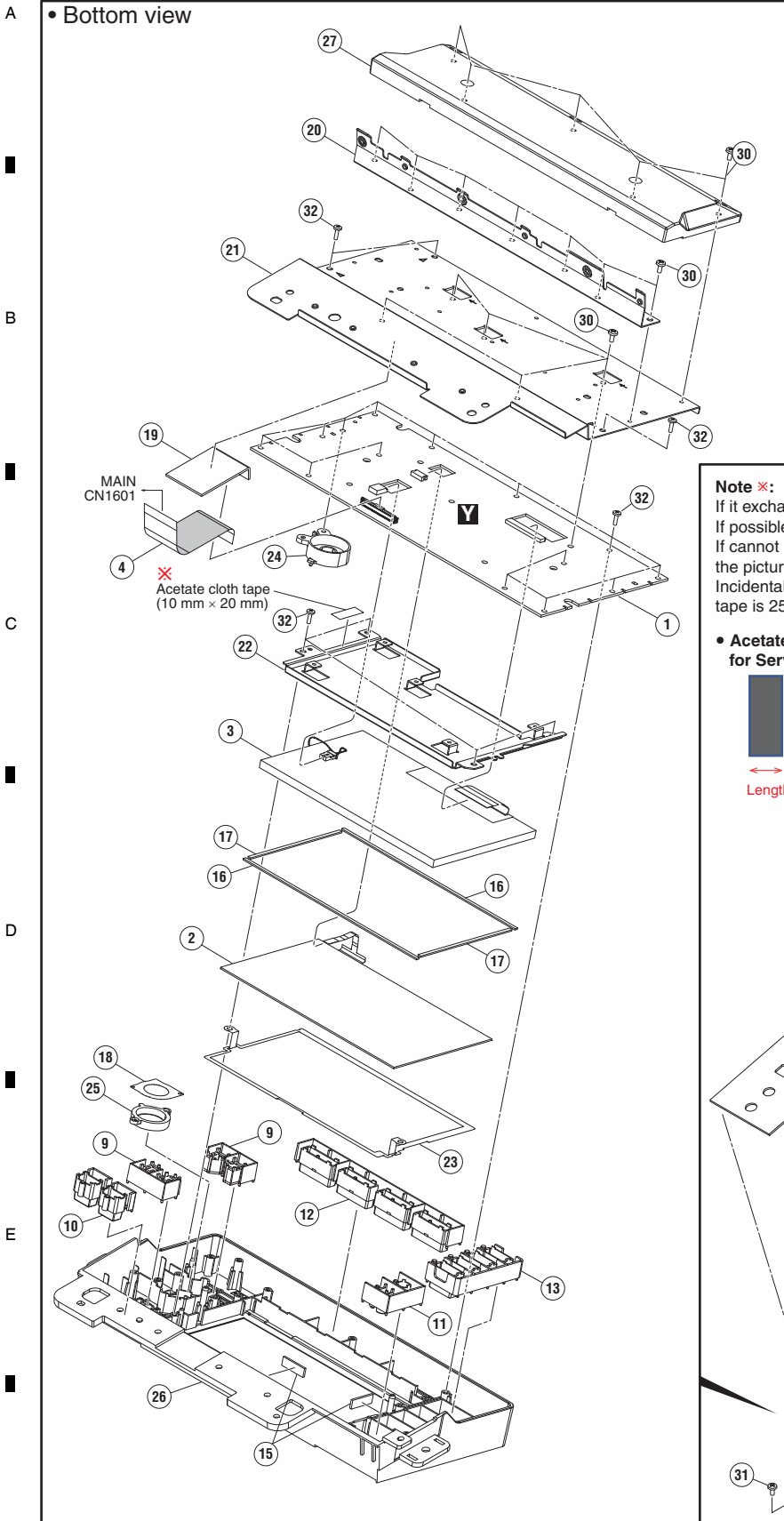

Note ✖:
 If it exchanges the Stay (2), be sure to use Acetate cloth tape.
 If possible, reuse the original tape.
 If cannot reuse, paste Acetate cloth tape of service parts as shown in the picture.
 Incidentally, width of original tape is 10 mm, but width of service parts tape is 25 mm.

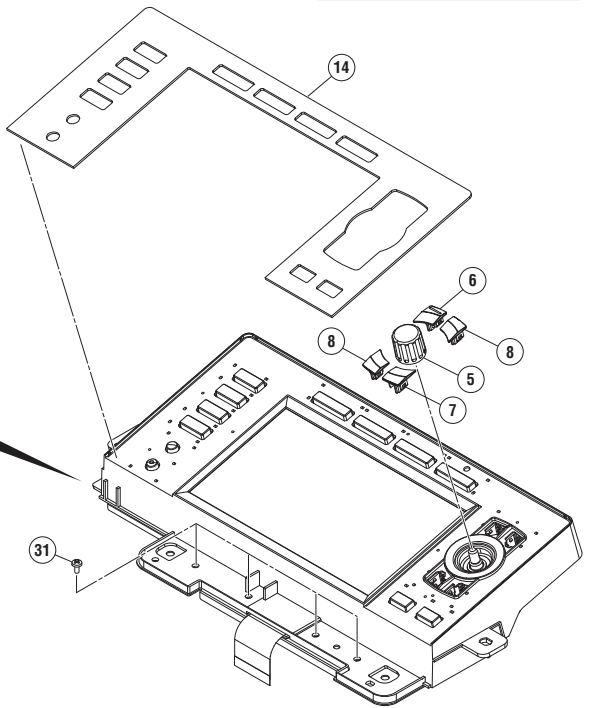
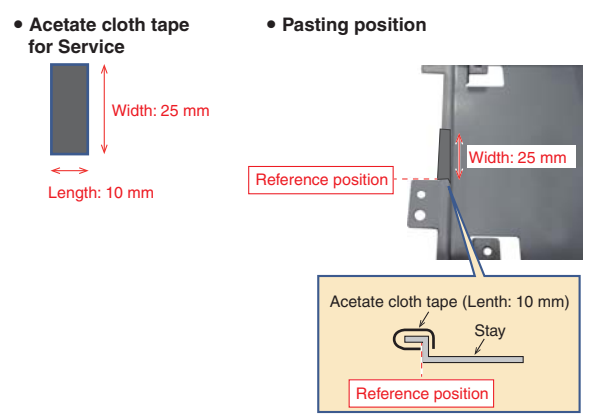

1

2

3

4

LCD SECTION PARTS LIST

<u>Mark No.</u>	<u>Description</u>	<u>Part No.</u>	
1	LCD Assy	DWX4036	
2	Touch Panel	DSX1130	A
3	TFT LCD	CWX4352	
4	FFC	DDD1811	
5	Dial Knob	DAA1246	
6	Button	DAC3113	
7	Button	DAC3117	
8	Button	DAC3118	
9	Button	DAC3289	
10	Button	DAC3290	
11	Button	DAC3291	B
12	Button	DAC3292	
13	Button	DAC3293	
14	Plate	DAH3156	
15	Packing/LCD	DEC3565	
16	Packing/L	DEC3568	
17	Packing/S	DEC3569	
18	Light-D Sheet	DEC3613	
19	Sheet	DEC3741	
20	Angle	DNH3307	C
21	Bracket	DNH3308	
22	Stay	DNH3309	
23	Plate	DNH3310	
24	Holder	DNK6467	
25	Lens	DNK6468	
⚠ 26	Panel	DNK6706	
27	Cover	DNK6707	
28	•••••		
29	•••••		
30	Screw	BBZ30P060FTB	D
31	Screw	BBZ30P060FTC	
32	Screw	BPZ26P080FTC	